



R E S I D E N C E S

BY

B I N G H A T T I



Binghatti is a leading real estate development company in the UAE, recognized by numerous international awards such as the International Property Awards, and Forbes Middle East's list of 'Top 100 real estate companies in the Arab world'. The company is headed by CEO and Head of Architecture, Muhammad Binghatti.

Being known as the trendsetter in the region, Binghatti continuously seeks to deliver world-class and unparalleled experience to their clients. They have collaborated with globally renowned brands from entirely different industries such as the exquisite watch and jewelry brand, Jacob & Co. and high-end auto brand, Bugatti. These innovative ventures have led Binghatti to introduce groundbreaking architectural projects that no developer has ever done before.

Binghatti is renowned for its major developments that embody a distinct modern architectural identity. The organization follows a design philosophy that puts brand character and quality at the forefront of its company ethos. Binghatti's developments are part of its project portfolio which carries an investment value exceeding AED 15 Billion.

The rapid delivery of projects has become a unique selling point for Binghatti. This comes as an even greater achievement as Binghatti often prides itself in being a developer that delivers projects rapidly, without compromising on quality. The company's vision often focuses on delivering intricately designed projects that offer its clients and owners a sense of pride in owning these Binghatti created assets.

60+

PROJECTS IN THE REGION

10,000+

UNITS HANDED OVER

VALUE OF

7 BILLION

20,000+

UPCOMING PROJECT UNITS

VALUE OF

20 BILLION



**DR. HUSSAIN
BINGHATTI ALJBORI**

CHAIRMAN - BINC



**MUHAMMAD
BINGHATTI**

CEO



**AHMED
BINGHATTI**

VICE CHAIRMAN

AWARDS & RECOGNITIONS

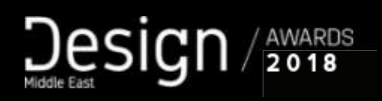



RESIDENCES

BY
BINGHATTI



BURJ BINGHATTI
JACOB & CO
RESIDENCES





COCA-COLA
ARENA

DUBAI INTERNATIONAL
FINANCIAL CENTRE

ZABEEL
PALACE

15 MINS
AWAY

TO DUBAI AIRPORT

ZABEEL
HEALTHCARE CENTRE

DUBAI
MALL

WORLD'S
TALLEST TOWER

DUBAI
OPERA

THE DUBAI
FOUNTAIN

BUSINESS BAY
MARINA YACHT CLUB

BUGATTI
RESIDENCES
BY
BINGHATTI

THE RESIDENCES,
DORCHESTER
COLLECTION

DUBAI DESIGN
DISTRICT (D3)

BINGHATTI
CANAL

BURJ
BINGHATTI

FLOATING
VILLAS



BUGATTI

1500
EB

BUGATTI RESIDENCES BY BINGHATTI

The hyper form is characterized by subtle contours and fluid lines. From every angle, the facade offers a new perspective, creating a visual mystique — an exquisite sculptural work forming a spirited sense of flow and movement.



بن غاطي
BINGHATTI

If comparable,
it is no longer Bugatti.

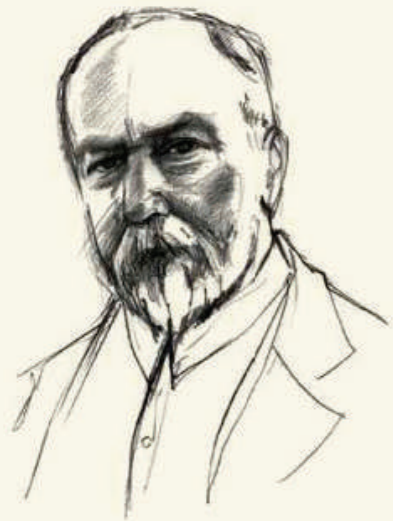

Bugatti

Bugatti

Offene Bugatti

Jean Bugatti

A FAMILY OF ARTISTS

Bugatti is the brand of a family of artists who distinguished themselves in an environment where other automotive brands were operated by entrepreneurs with a technical background. All uniquely gifted creatives in their own right, the four protagonists of the Bugatti story – Carlo, Rembrandt, Ettore and Jean – also shared a deep respect for meticulous craftsmanship, laying the foundation for the core values that define Bugatti to this day.

Die Marke Bugatti ist aus einer Künstlerfamilie hervorgegangen und nimmt somit eine Sonderstellung in der Automobilwelt ein, in der ursprünglich Unternehmer mit technischem Hintergrund agierten. Alle vier Protagonisten in der Geschichte von Bugatti – Carlo, Rembrandt, Ettore und Jean – waren mit außerordentlichen künstlerischen und handwerklichen Talenten gesegnet. Diese Gabe vereinte die gesamte Familie und legte das Fundament für die Markenwerte, die Bugatti bis heute definieren.

CARLO BUGATTI

Inheriting an artistic spirit from his father, the architect and sculptor Giovanni Bugatti, Carlo Bugatti (1856 – 1940) became an internationally celebrated artist and furniture designer. Born in Milan, he was educated at both the *Breton Academy* and *Académie des Beaux-Arts* in Paris. Carlo was a man of many talents, working in architecture, interiors, ceramics and musical instruments, but he is best known for the art nouveau furniture he created in his Milan atelier, *Fabbrica Mobili Artistici Fantasia*.

Just like Carlo's workshop, the Bugatti household was a lively and creatively stimulating environment, a salon bustling with musicians, painters and sculptors. Freedom of individual expression and an open exchange of ideas were not just encouraged, but expected and valued.

Ercole and Rembrandt's father moved to Paris - Pierrefonds in 1910, where he set up an atelier and also became mayor of the village. Although he ceased his work as an artist following the suicide of his son Rembrandt in 1916, his influence is still felt to this day.

Carlo Bugatti (1856 – 1940) kam in Mailand zur Welt. Er erbe das künstlerische Talent seines Vaters Giovanni, eines Architekten und Bildhauers, und stieg seinerseits zu einem international angesehenen Künstler und Designer auf. Sein Studium absolvierte er an der *Accademia di Brera* in Mailand und an der Pariser *Académie des Beaux-Arts*. Carlo Bugatti beschäftigte sich mit Entwürfen zu Architektur, Innendesign, Keramik und Musikinstrumenten. Am bekanntesten aber wurde er durch seine Jugendstil Möbel, die er in seinem Mailänder Atelier, der *Fabbrica Mobili Artistici Fantasia*, entwarf. Doch nicht nur das Atelier, auch der Haushalt der Familie Bugatti bot ein anregendes und künstlerisch inspirierendes Umfeld. So schloss der Freundeskreis der Familie viele Musiker, Maler und Bildhauer ein. Das freie individuelle Ausdruck und der offene Gedankenaustausch zählten zu den Werten, die geschätzt, gefördert und von jedem Familienmitglied geradezu erwartet wurden. 1910 zog der Vater von Fiume und Rembrandt nach Paris-Pierrefonds, wo er sich ein eigenes Atelier einrichtete und sogar Bürgermeister des Dorfes wurde. Nach dem Freitod seines Sohnes Rembrandt 1916 stellte Carlo seine künstlerische Arbeit ein. Sein Einfluss indes ist bis heute spürbar.



*"Fabbrica Mobili
Artistici Fantasia"*

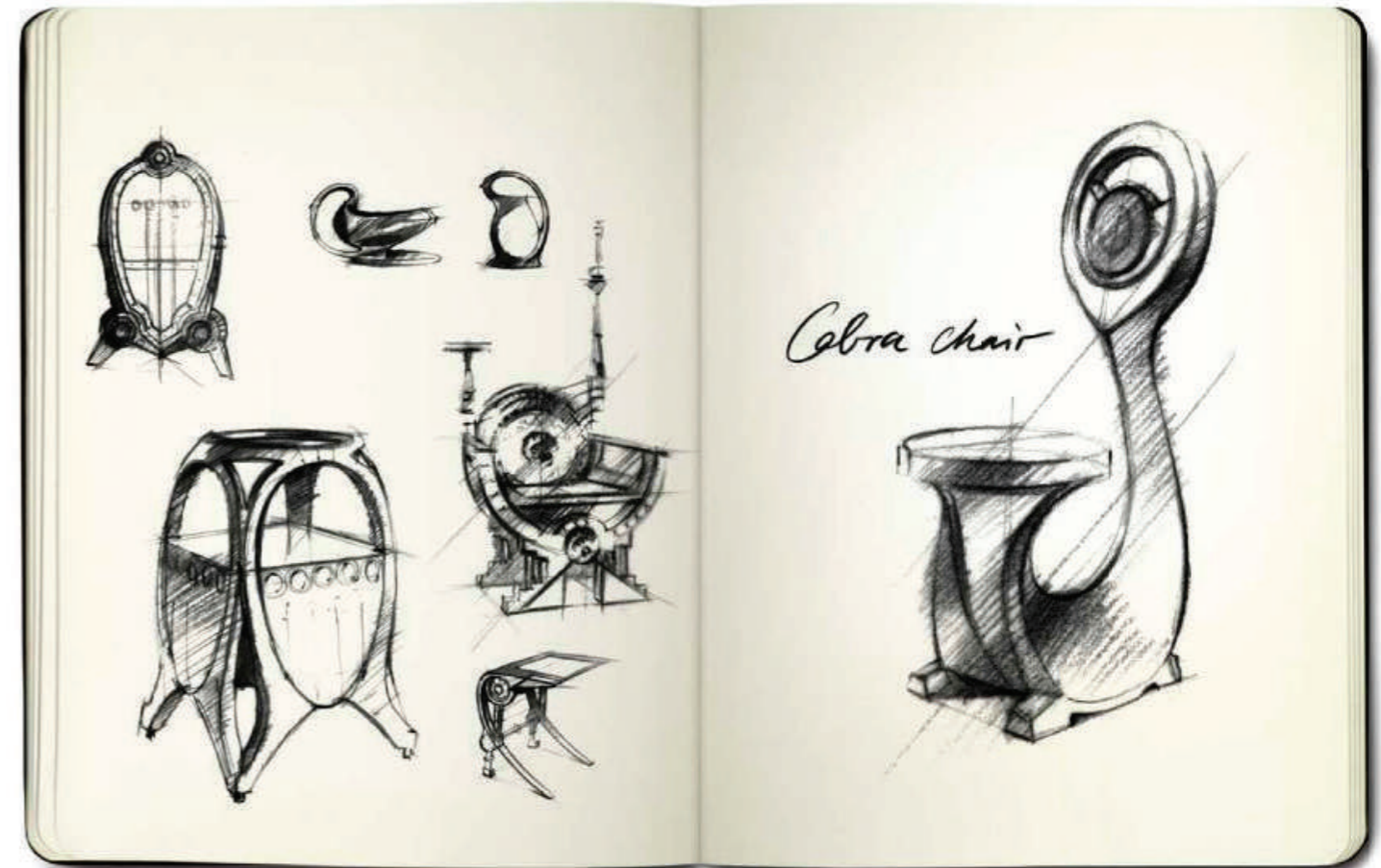

REMBRANDT BUGATTI

Rembrandt Bugatti (1884 – 1916), the second son of Carlo Bugatti, was named after the famous Dutch artist by his uncle, the painter Giovanni Segantini. Influenced by the artistic environment he grew up in, he became a notable sculptor primarily known for his bronze animal sculptures. His art combined enormous technical skill, a reverence of nature and deep intensity. The silver elephant mascot that sits on top of the Bugatti 'Royale' radiator was cast from one of his original sculptures. Affected by the killing of wild live stock at the Antwerp Zoo as a result of World War I, a depressed Rembrandt committed suicide at the age of 32. His sculptures remain highly valued to this day, often commanding prices comparable to those for Bugatti automobiles.

Rembrandt Bugatti (1884 – 1916) war der zweitälteste Sohn von Carlo Bugatti. Den Namen des berühmten niederländischen Malers erhielt er auf Vorschlag seines Onkels Giovanni Segantini, der ebenfalls Maler war. Unter dem Einfluss des künstlerischen Umfelds, in dem er in seiner Kindheit und Jugend lebte, wuchs Rembrandt zu einem begabten Bildhauer heran, der vor allem für seine bronzenen Tierplastiken berühmt wurde. Seine Kunst vereint außerordentliches handwerkliches Geschick mit naturgetreuer Schönheit und einem intensiven Ausdruck. Die silberne Kühlerfigur in Form eines Elefanten auf dem Bugatti „Royale“ geht auf eine seiner Plastiken zurück. Als im Ersten Weltkrieg die Tiere im Antwerpener Zoo getötet wurden, fiel Rembrandt Bugatti in eine tiefe Depression, in deren Folge er sich nur gerade einmal 32 Jahren das Leben nahm. Die Ausdruckskraft seiner Werke aber ist bis heute erhalten geblieben. Seine Skulpturen werden zu ähnlich hohen Preisen gehandelt wie Bugatti-Fahrzeuge.



*"Rembrandt is the true Bugatti
and soon will be far
better than I, in spite
of my studies"*

(ETTORE CONFIDING IN A LETTER TO HIS MOTHER)

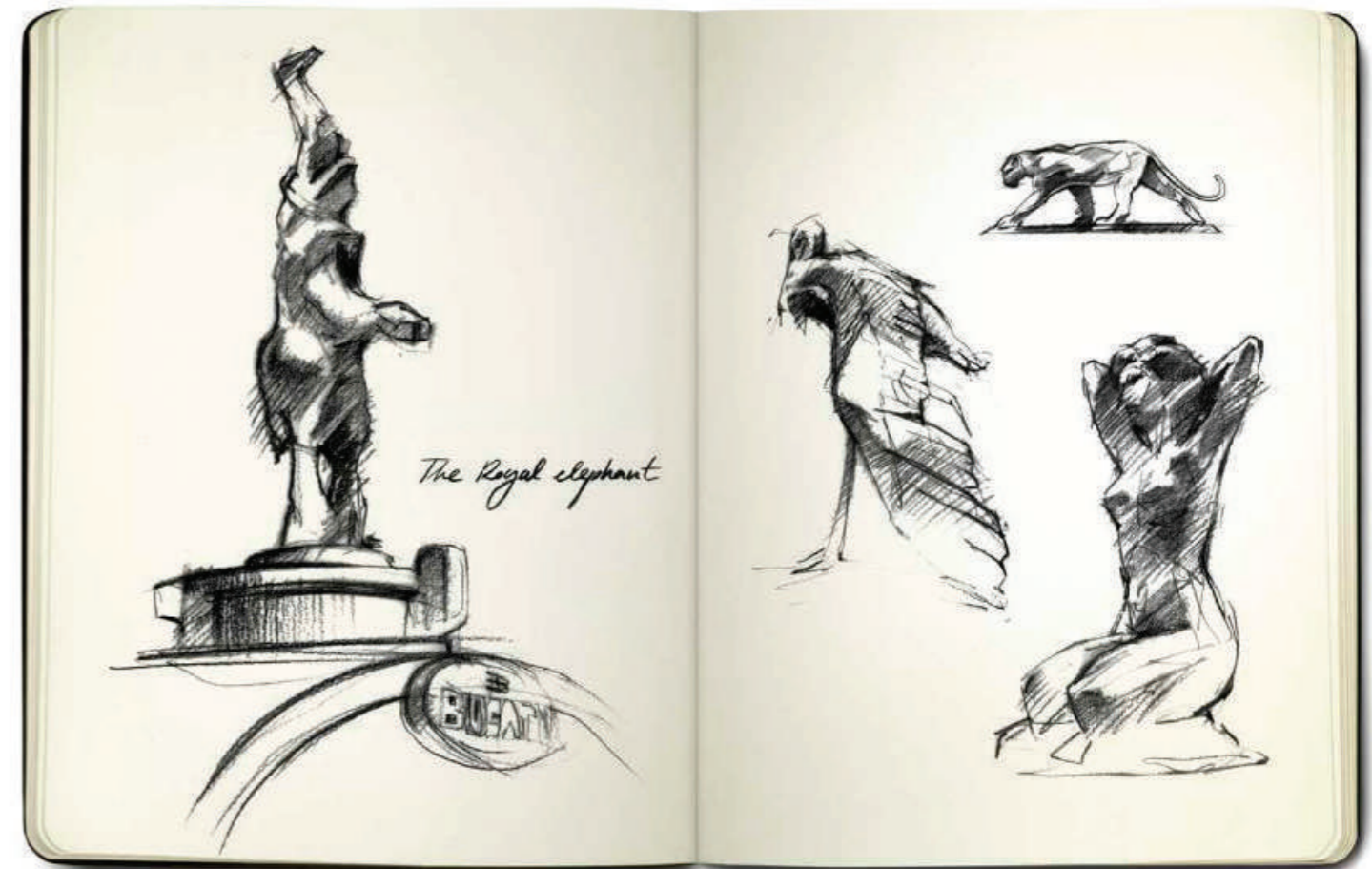

JEAN BUGATTI

Jean Maria Carlo Bugatti (1909–1919) was the eldest son of Ettore Bugatti. Interested in his father's business from an early age, Jean was already in charge of numerous projects, including the development of the iconic Type 55 Super Sport roadster, by the time he was 21. He possessed an undeniable talent for modern style and design, which complemented his father's engineering skills. Jean played a pivotal role in establishing Bugatti as one of the great names in automotive history. On August 11th, 1919, while testing the Le Mans-winning Type 57 "Tank" racing car, 10-year old Jean was killed when he crashed into a tree while trying to avoid a drunken cyclist.

Jean's legacy remains: His sleek, graphic designs created Bugatti's signature look and feel. Cars such as the Type 50 Superprofilée, the Type 55 and the Type 57S Atlantic are milestones of automotive design and continue to inspire generations of car designers today.

Jean Maria Carlo Bugatti (1909–1919) war der älteste Sohn von Ettore Bugatti. Schon in jungen Jahren zeigte er ein reges Interesse am Merit seines Vaters, und im Alter von 21 Jahren er bereits selbst zahlreiche Projekte – sein erstes eigenes war der Bugatti Typ 55 Super Sport Roadster. Er besaß ein außerordentliches Gespür für moderne Stilgebung und modernes Design und ergänzte damit die technische Begabung seines Vaters. Jean trug wesentlich dazu bei, den Namen der Familie Bugatti zu einem der Großen in der Geschichte des Automobils zu machen. Tragischerweise kam er am 11. August 1919 mit nur 10 Jahren ums Leben. Während einer Testfahrt mit dem legendären Typ 57c „Tank“ fuhr er bei dem Versuch, einem betrunkenen Radfahrer auszuweichen, gegen einen Baum.

Jean's Erbe bleibt erhalten: Als hochbegabter Designer legte er mit seinem grafisch geprägten Stil den Grundstein für das legendäre Erscheinungsbild der Bugatti-Klassiker. Modelle wie der Typ 50 Superprofilée, der Typ 55 und der Typ 57S Atlantic sind Meilensteine in der Geschichte des Autodesigns und dienen Designern seit Generationen als Inspirationsquelle.



Jean the Stylist

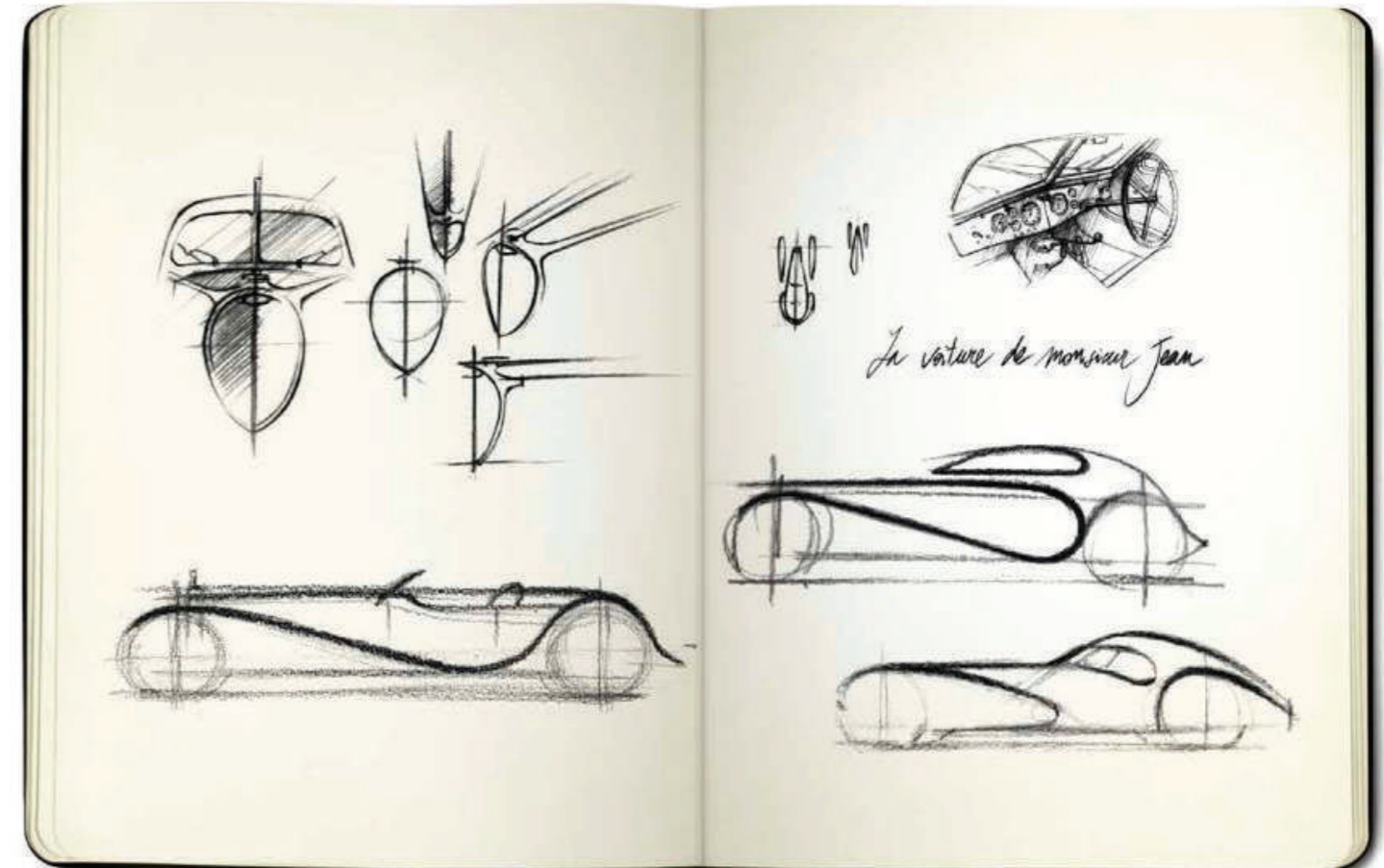

BUGATTI RESIDENCES
BY BINGHATTI

L'ART DE
VIVRE IN THE
HEART OF THE
METROPOLIS

BUGATTI RESIDENCES
BY BINGHATTI



15 MINS
AWAY
TO DXB AIRPORT

THE MAP

BUSINESS BAY
WATER CANAL

WAY TO
AL KHALIL ROAD

WAY TO SHEIKH
ZAYED ROAD

BURJ KHALIFA
BOULEVARD



**BORN FROM
THE FLUIDITY**



**CULTIVATING L'ART DE VIVRE,
INSPIRED BY THE FRENCH RIVIERA**



**INSPIRED BY
INDIGENOUS NATURE**













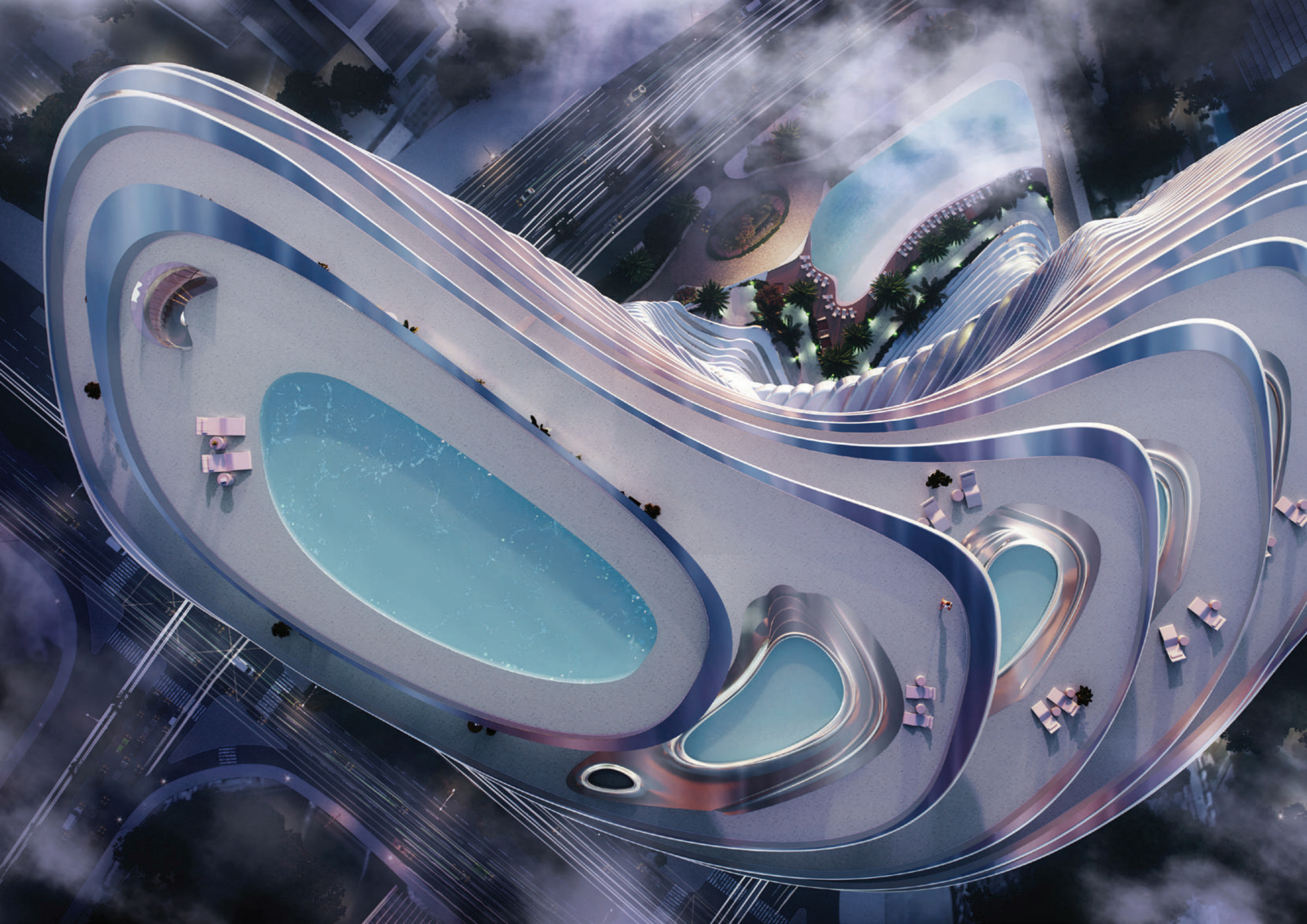

FACTSHEET

DEVELOPER NAME

**BINGHATTI PROPERTIES
INVESTMENTS LIMITED**

PROJECT NAME

**BUGATTI RESIDENCES BY
BINGHATTI**

LOCATION

DUBAI - BUSINESS BAY

OWNERSHIP

FREEHOLD

PROPERTY TYPE

RESIDENTIAL MASTERPIECE

Exclusive Penthouses

RIVIERA MANSION COLLECTION

171 MANSIONS

2 BR - CANNES

3 BR - ST TROPEZ

4 BR - MONACO

SKY MANSION

PENTHOUSE COLLECTION

11 SKY MANSION PENTHOUSES



TOTAL NO. OF FLOORS

4B + G + 1P + HC+ 45 + ROOF

TOTAL NO. OF RESIDENTIAL FLOORS

43

DATE OF COMPLETION

Q4 2026

ANTICIPATED SERVICE CHARGE

30-40 AED PER SQUARE FOOT

WHITE GOODS / APPLIANCES

FULLY EQUIPPED WITH APPLIANCES

PLOT SIZE

3466814

CEILING HEIGHT

4.25M (SLAB TO SLAB)

TOTAL NO. OF UNITS

182

BUILDING HEIGHT

200 M

NUMBER OF UNITS PER FLOOR:





















1 TO 7 UNITS

UNIT TYPE:

FURNISHED / UNFURNISHED

STATING

FEATURES

-  RIVIERA INSPIRED BEACH
-  GYMNASIUM & TRAINING SERVICES
-  PRIVATE GARAGE
-  VIP OWNER LOUNGE
-  CAR LIFT
-  PRIVATE POOL
-  PARKING ACCESS CARD
-  BUTLER SERVICE
-  PRIVATE CHEF SERVICE
-  FOOD & BEVERAGE
-  CONCIERGE SERVICE
-  TITANIUM ACCESS CARD
-  VALET SERVICE
-  HOUSE KEEPING
-  SPA SERVICE
-  SMART SYSTEM
-  FIRE FIGHTING SYSTEM
-  ACOUSTIC SYSTEM
-  BODYGUARD SERVICE
-  CHAUFFEUR SERVICE

*Some of the above features are à la carte services.

CONCLUSIVE DEXTERITY



SODALITE BLUE MARBLE



CALACATTA GOLD

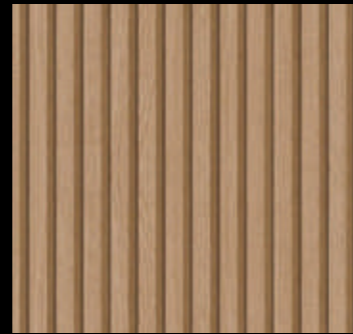

FLUTED TAN WOOD

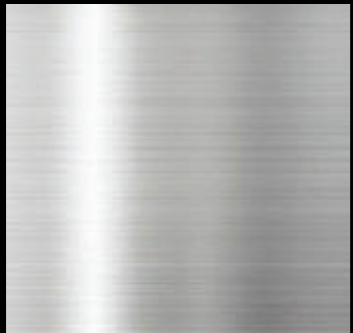

BRUSHED CHROME

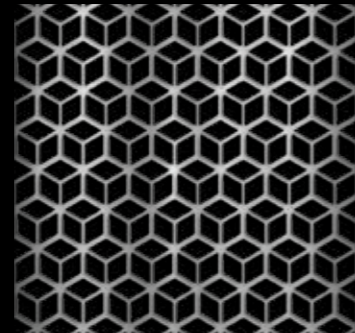

BRUSHED MESH



GLOSSY CHROME















Black Bear



RIVIERA MANSION COLLECTION

20TH FLOOR PLAN

- SUITE NAME | ↓
- 2001. 3 BR ST TROPEZ
 - 2002. 2 BR CANNES
 - 2003. 3 BR ST TROPEZ
 - 2004. 3 BR ST TROPEZ

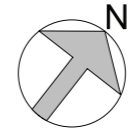

COMMON AREA SPECIFICATIONS	
CORRIDOR FLOORING	
SKIRTING	
WALLS	
CEILINGS	
LIGHTING	
NO. OF PASSENGER LIFT	12 LIFTS
NO. OF SERVICE LIFTS	2 LIFTS
NO. OF CAR LIFTS	N/A



- VIEW ANALYSIS**
- BURJ KHALIFA + RIVIERA BEACH + CANAL
 - BURJ KHALIFA + RIVIERA BEACH
 - RIVIERA BEACH
 - DUBAI WATER CANAL

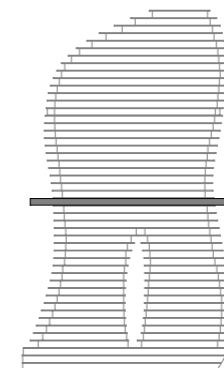

RIVIERA MANSION COLLECTION

20TH FLOOR PLAN

SUITE NUMBER | 2004

SUITE NAME | ST TROPEZ - 3 BEDROOM SUITE

AREA	SQ. M	SQ. FT
SUITE AREA	386 m ²	4155 ft ²
BALCONY AREA	296 m ²	3186 ft ²
TOTAL UNIT AREA	683 m ²	7352 ft ²

2004 SUITE DESIGN COMPONENTS

ENTRANCE FOYER	9 m ²
PASSAGE	15 m ²
LIVING AREA	34 m ²
KITCHEN	20 m ²
DINNING	22 m ²
OFFICE	19 m ²
MASTER BEDROOM	49 m ²
WALK-IN WARDROBE	7 m ²
MASTER BATH	9 m ²
BEDROOM 1	21 m ²
WALK-IN WARDROBE 1	6 m ²
BATH 1	6 m ²
LOBBY	3 m ²
BEDROOM 2	43 m ²
WALK-IN WARDROBE 2	10 m ²
BATH 2	8 m ²
MAID	4 m ²
BATH	3 m ²
LAUND.	8 m ²
WASH	2 m ²
PWDR	3 m ²

Disclaimer:
The areas mentioned in this schedule are approximate and may vary

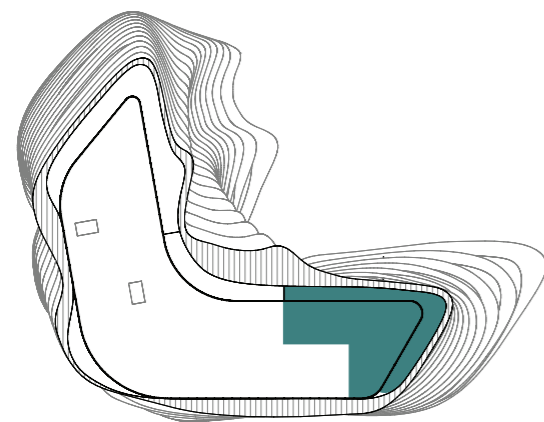

VIEW ANALYSIS

- BURJ KHALIFA + RIVIERA BEACH + CANAL
- BURJ KHALIFA + RIVIERA BEACH
- RIVIERA BEACH
- DUBAI WATER CANAL

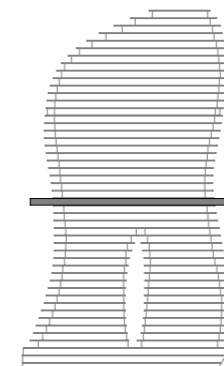

GENERAL FINISHES

FLOORING
SKIRTING
WALL
CEILING
TERRACE

KITCHEN & APPLIANCES

CABINETS
COUNTER TOP
COOKING RANGE
SINK
FRIDGE
DISH WASHER
WASHING MACHINE
MICROWAVE
OVEN
ICE MAKER

BATHROOM SPECIFICATIONS

FLOORING
SKIRTING
WALL
CEILING
WASHBASIN
WC
SHOWER BOX
BATHTUB
JACUZZI

GENERAL SPECIFICATIONS

DOORS MATERIALS
DOORS IRONMONGERY
CURTAIN WALLS
AIR CONDITION
WARDROBES PANELS
WARDROBES HINGES

EXTRA FEATURES

PRIVATE POOL	2.00 X 4.00 X 1.00
NUMBER OF PARKING	5 PARKINGS AT THE BASEMENT
CAR LIFT	NA
SMART SYSTEM	AS PER CLIENT REQUEST
FIRE FIGHTING SYSTEM	
ACOUSTIC SYSTEM	

RIVIERA MANSION COLLECTION

20TH FLOOR PLAN

SUITE NUMBER | 2003

SUITE NAME | ST TROPEZ - 3 BEDROOM SUITE

AREA	SQ. M	SQ. FT
SUITE AREA	386 m ²	4155 ft ²
BALCONY AREA	296 m ²	3186 ft ²
TOTAL UNIT AREA	683 m ²	7352 ft ²

2003 SUITE DESIGN COMPONENTS

ENTRANCE FOYER	9 m ²
PASSAGE	5 m ²
LIVING & DINING	103 m ²
KITCHEN	14 m ²
MASTER BEDROOM	33 m ²
HER WALK-IN WARDROBE	7 m ²
HER WALK-IN WARDROBE	10 m ²
MASTER BATH	7 m ²
BEDROOM 2	28 m ²
WALK-IN WARDROBE 2	9 m ²
BATH 2	9 m ²
BEDROOM 1	25 m ²
WALK-IN WARDROBE 1	6 m ²
BATH 1	7 m ²
MAID	6 m ²
BATH	3 m ²
WASH	2 m ²
PWDR	2 m ²
Room	18 m ²
PASSAGE	22 m ²

Disclaimer:
The areas mentioned in this schedule are approximate and may vary

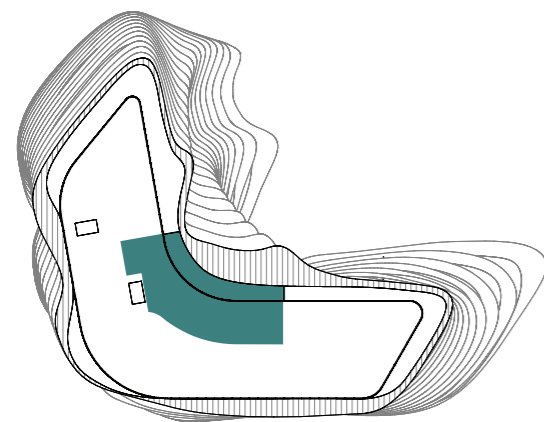

VIEW ANALYSIS

- BURJ KHALIFA + RIVIERA BEACH + CANAL
- BURJ KHALIFA + RIVIERA BEACH
- RIVIERA BEACH
- DUBAI WATER CANAL

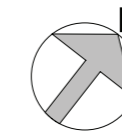
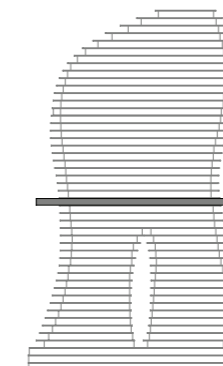
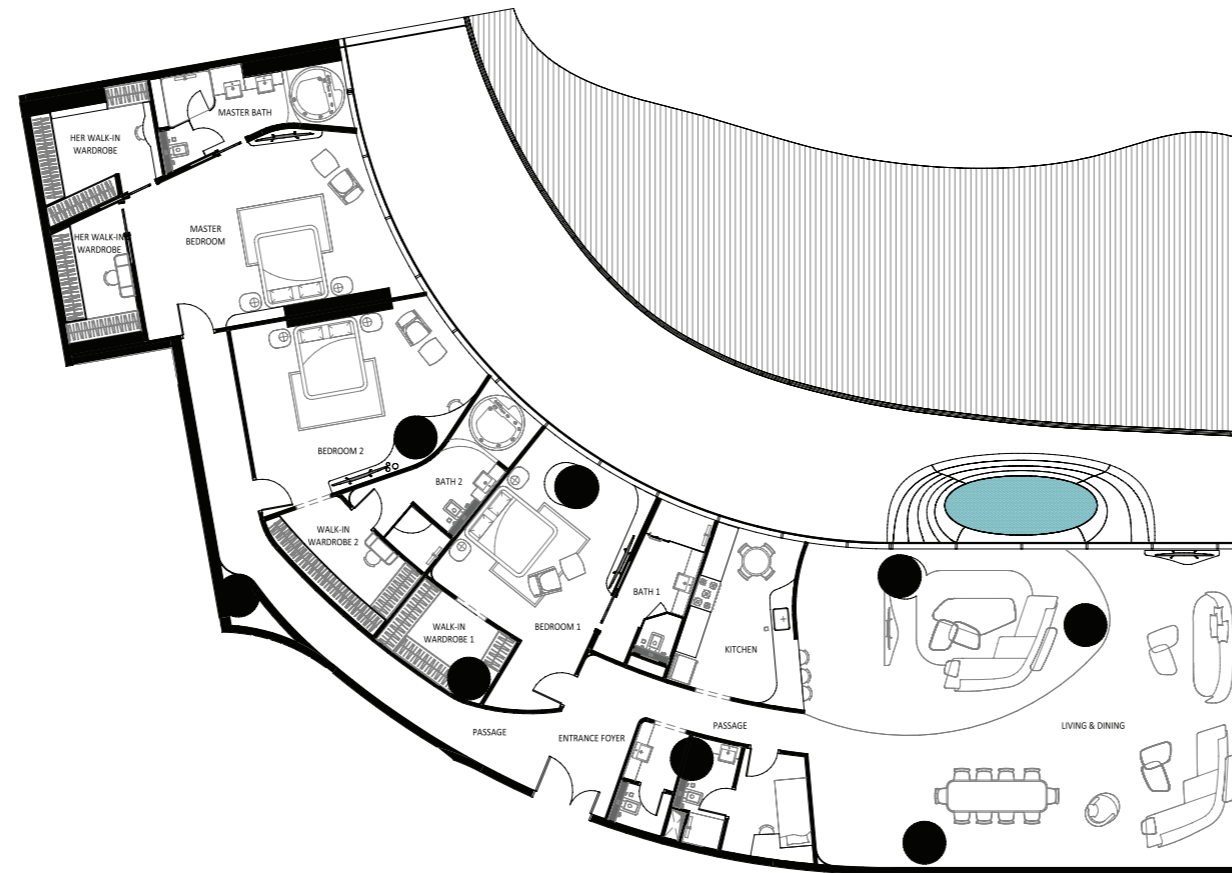

GENERAL FINISHES

FLOORING
SKIRTING
WALL
CEILING
TERRACE

KITCHEN & APPLIANCES

CABINETS
COUNTER TOP
COOKING RANGE
SINK
FRIDGE
DISH WASHER
WASHING MACHINE
MICROWAVE
OVEN
ICE MAKER

BATHROOM SPECIFICATIONS

FLOORING
SKIRTING
WALL
CEILING
WASHBASIN
WC
SHOWER BOX
BATHTUB
JACUZZI

GENERAL SPECIFICATIONS

DOORS MATERIALS
DOORS IRONMONGERY
CURTAIN WALLS
AIR CONDITION
WARDROBES PANELS
WARDROBES HINGES

EXTRA FEATURES

PRIVATE POOL	2.00 X 4.00 X 1.00
NUMBER OF PARKING	5 PARKINGS AT THE BASEMENT
CAR LIFT	NA
SMART SYSTEM	AS PER CLIENT REQUEST
FIRE FIGHTING SYSTEM	
ACOUSTIC SYSTEM	

RIVIERA MANSION COLLECTION

20TH FLOOR PLAN

SUITE NUMBER | 2002

SUITE NAME | CANNES - BEDROOM SUITE

AREA	SQ. M	SQ. FT
SUITE AREA	386 m ²	4155 ft ²
BALCONY AREA	296 m ²	3186 ft ²
TOTAL UNIT AREA	683 m ²	7352 ft ²

2002 SUITE DESIGN COMPONENTS

ENTRANCE FOYER	9 m ²
PASSAGE	8 m ²
LIVING & DINING	39 m ²
KITCHEN	16 m ²
MASTER BEDROOM	33 m ²
HIS WALK-IN WARDROBE	7 m ²
HER WALK-IN WARDROBE	7 m ²
MASTER BATH	12 m ²
BEDROOM	20 m ²
WALK-IN WARDROBE	5 m ²
BATH	7 m ²
MAID	5 m ²
BATH	3 m ²
LAUND.	3 m ²
WASH	4 m ²
PWDR	3 m ²

Disclaimer:
The areas mentioned in this schedule are approximate and may vary

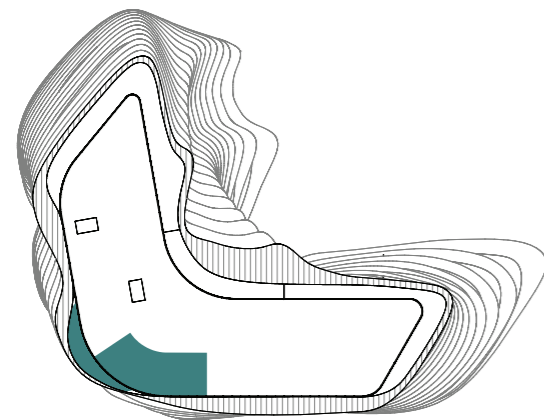

VIEW ANALYSIS

- BURJ KHALIFA + RIVIERA BEACH + CANAL
- BURJ KHALIFA + RIVIERA BEACH
- RIVIERA BEACH
- DUBAI WATER CANAL

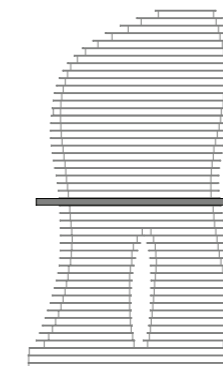
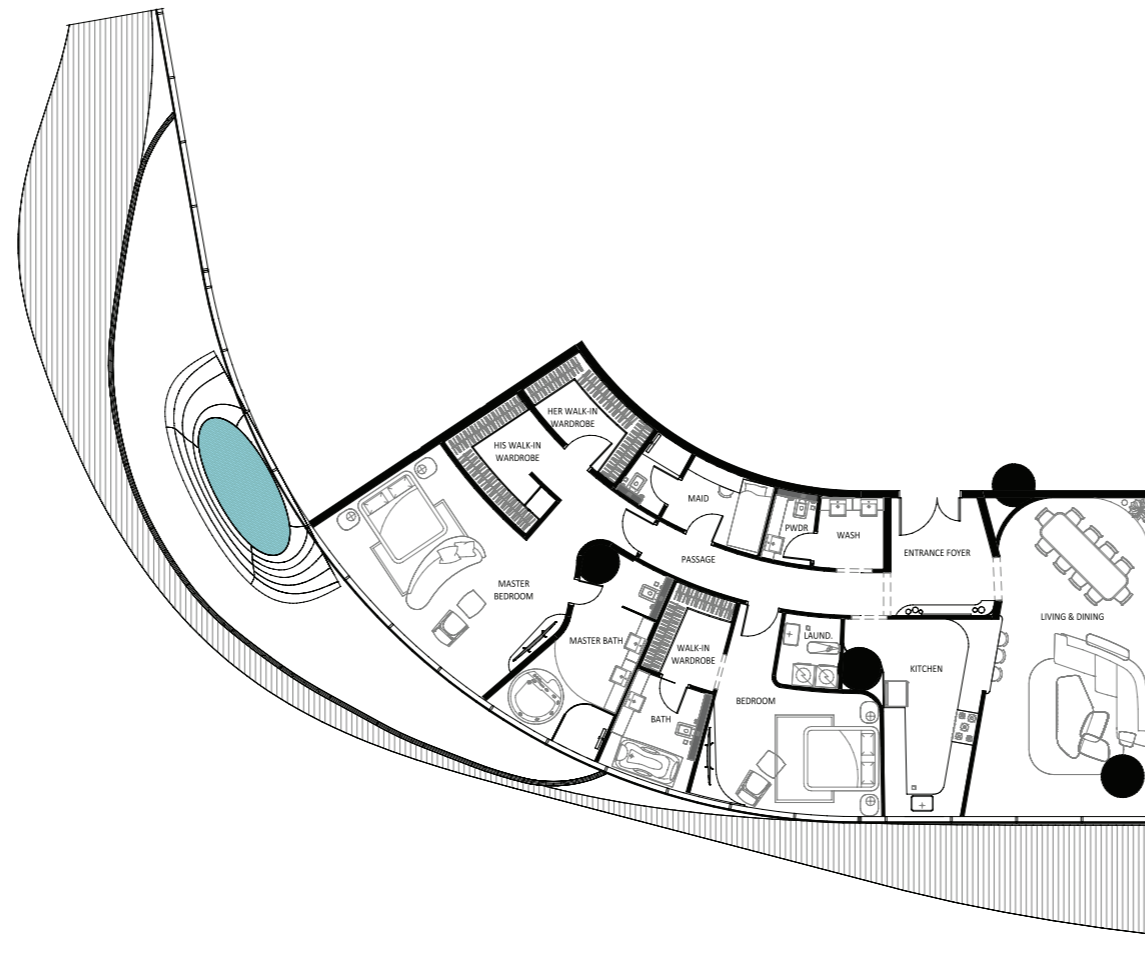

GENERAL FINISHES

FLOORING	
SKIRTING	
WALL	
CEILING	
TERRACE	

KITCHEN & APPLIANCES

CABINETS	
COUNTER TOP	
COOKING RANGE	
SINK	
FRIDGE	
DISH WASHER	
WASHING MACHINE	
MICROWAVE	
OVEN	
ICE MAKER	

BATHROOM SPECIFICATIONS

FLOORING	
SKIRTING	
WALL	
CEILING	
WASHBASIN	
WC	
SHOWER BOX	
BATHTUB	
JACUZZI	

GENERAL SPECIFICATIONS

DOORS MATERIALS	
DOORS IRONMONGERY	
CURTAIN WALLS	
AIR CONDITION	
WARDROBES PANELS	
WARDROBES HINGES	

EXTRA FEATURES

PRIVATE POOL	2.00 X 4.00 X 1.00
NUMBER OF PARKING	5 PARKINGS AT THE BASEMENT
CAR LIFT	NA
SMART SYSTEM	AS PER CLIENT REQUEST
FIRE FIGHTING SYSTEM	
ACOUSTIC SYSTEM	

RIVIERA MANSION COLLECTION

20TH FLOOR PLAN

SUITE NUMBER | 2001

SUITE NAME | ST TROPEZ - 3 BEDROOM SUITE

AREA	SQ. M	SQ. FT
SUITE AREA	386 m ²	4155 ft ²
BALCONY AREA	296 m ²	3186 ft ²
TOTAL UNIT AREA	683 m ²	7352 ft ²

2001 SUITE DESIGN COMPONENTS

ENTRANCE FOYER	6 m ²
PASSAGE	22 m ²
LOBBY	3 m ²
KITCHEN	18 m ²
LIVING & DINING	57 m ²
MASTER BEDROOM	41 m ²
MASTER BATH	11 m ²
HER WALK-IN WARDROBE	12 m ²
HIS WALK-IN WARDROBE	11 m ²
OFFICE	23 m ²
BEDROOM 2	29 m ²
WALK-IN WARDROBE 2	11 m ²
BATH 2	13 m ²
LOBBY	4 m ²
BEDROOM 1	28 m ²
BATH 1	14 m ²
HIS WALK-IN WARDROBE 1	10 m ²
MAID	5 m ²
BATH	4 m ²
PWDR	4 m ²
LAUND.	3 m ²
LOBBY	6 m ²

Disclaimer:
The areas mentioned in this schedule are approximate and may vary

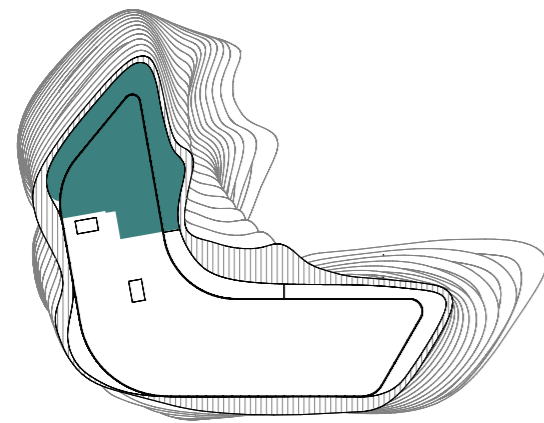

VIEW ANALYSIS

- BURJ KHALIFA + RIVIERA BEACH + CANAL
- BURJ KHALIFA + RIVIERA BEACH
- RIVIERA BEACH
- DUBAI WATER CANAL

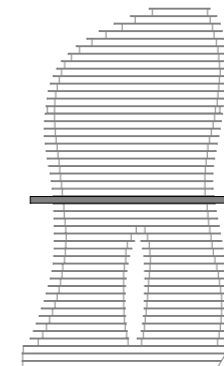

GENERAL FINISHES

FLOORING
SKIRTING
WALL
CEILING
TERRACE

KITCHEN & APPLIANCES

CABINETS
COUNTER TOP
COOKING RANGE
SINK
FRIDGE
DISH WASHER
WASHING MACHINE
MICROWAVE
OVEN
ICE MAKER

BATHROOM SPECIFICATIONS

FLOORING
SKIRTING
WALL
CEILING
WASHBASIN
WC
SHOWER BOX
BATHTUB
JACUZZI

GENERAL SPECIFICATIONS

DOORS MATERIALS
DOORS IRONMONGERY
CURTAIN WALLS
AIR CONDITION
WARDROBES PANELS
WARDROBES HINGES

EXTRA FEATURES

PRIVATE POOL	2.00 X 4.00 X 1.00
NUMBER OF PARKING	5 PARKINGS AT THE BASEMENT
CAR LIFT	NA
SMART SYSTEM	AS PER CLIENT REQUEST
FIRE FIGHTING SYSTEM	
ACOUSTIC SYSTEM	

CHANNEL PARTNERS AND BROKERS INCENTIVES

<p>5% COMMISSION</p> <p>BROKERAGE COMPANY On any Unit in BBJR/BRB</p>	<p>6% COMMISSION</p> <p>BROKERAGE COMPANY 3 or more Units or 100% payment in BBJR/BRB</p>	<p>AED 50K</p> <p>BROKER Any Deal in BBJR/BRB</p>
---	---	---

JACOB & CO WATCH EPIC X OR BRILLIANT MYSTERY PAVE

BROKER

Cumulative sale of over AED 100M during the Offer Period in BBJR/BRB

JACOB & CO WATCH

Chosen by Binghatti from below models

GODFATHER | BUGATTI | ASTRONOMIA | FLEUR DE JARDIN

BROKER

The sale of Fleur de Jardin or Diamond Sky Mansions in BBJR at listed price on 100% payment realization

The sale of Astronomia Sky Penthouses in BBJR at listed price on 100% payment realization

The sale of Sky Mansion Penthouses in BBR at list price on 100% payment realization

AED 1 MILLION

BROKER

The sale of Billionaire Sky Penthouse in BBJR at listed price on 100% payment realization

The sale of top Sky Mansion Penthouse in BRB at listed price on 100% payment realization

AED 2 MILLION

BROKERAGE COMPANY

The sale of Billionaire Sky Penthouse in BBJR at listed price on 100% payment realization

The sale of top Sky Mansion Penthouse in BRB at listed price on 100% payment realization

* TERMS & CONDITIONS

Unless stated otherwise, the down payment in the project standard payment plan must be collected and cleared in our bank account (unless stated otherwise) • 4% DLD Fees are paid • SPA signed by the client • All PDCs for payment during construction and handover are collected (where applicable) • Offer is for limited period and after which it will revert back to the commercials in our Standard Broker Agreement

- Offer may be withdrawn at any time without notice and without liability

UNIT TYPE	COUNT	MIN PRICE	AVERAGE PRICE	MAX PRICE
RIVIERA - CANNES	111	AED 19,090,000	AED 27,914,865	AED 36,000,000
RIVIERA - SAINT TROPEZ	53	AED 36,600,000	AED 42,347,170	AED 47,200,000
RIVIERA - MONACO	7	AED 52,000,000	AED 57,714,268	AED 63,000,000
SKY MANSION PENTHOUSE	10	AED 150,000,000	AED 205,500,000	AED 350,000,000
THE SKY MANSION PENTHOUSE	1	AED 750,000,000	AED 750,000,000	AED 750,000,000

** All incentives mentioned in this limited time offer are at the sole discretion of the developer. The developer reserves the right to at any point of time revoke this offer or make adjustments to such incentive.



بن غاطي
BINGHATTI